

## Technical Specification

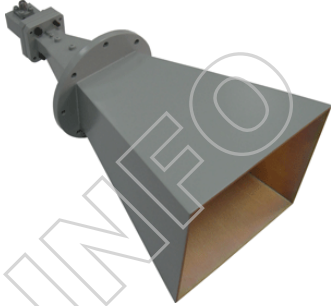

Frequency Range (GHz)	6.5 - 18.0
Gain(dB)	20 Typ.
Polarization	Linear
VSWR	2.0 Max
Cross Polarization Isolation(dB)	30 Typ.
Waveguide(A Type)	WRD650D28
Adapter(C Type)	650DRWCAS or 650DRWCAN
Connector(C Type)	SMA-F or N-F
Size	124x104x262 (Including Adapter)
Net Weight(Kg)	0.75 Around (Including Adapter)

## Outline Drawing (Size: mm) Including Adapter

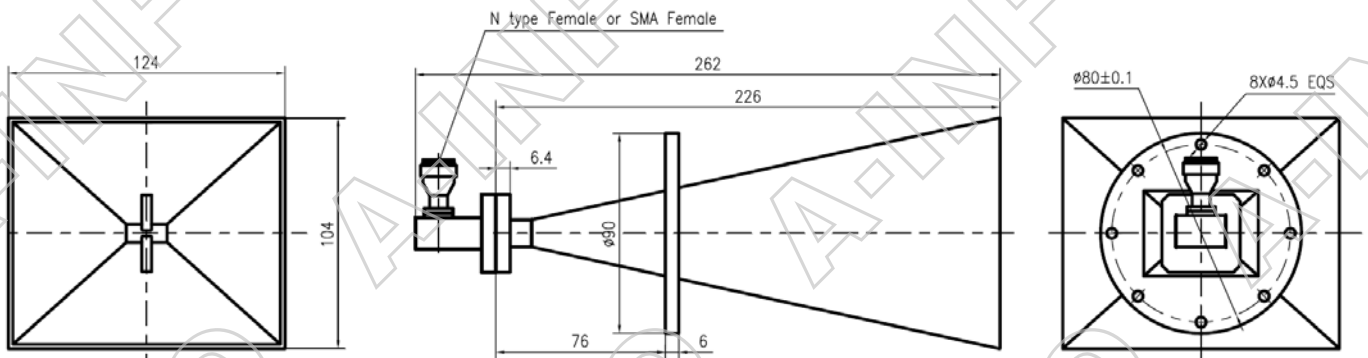

## Flange Drawing (Size: mm)

### FPWRD650D28

(With two through mounting holes  
and two screws holes)

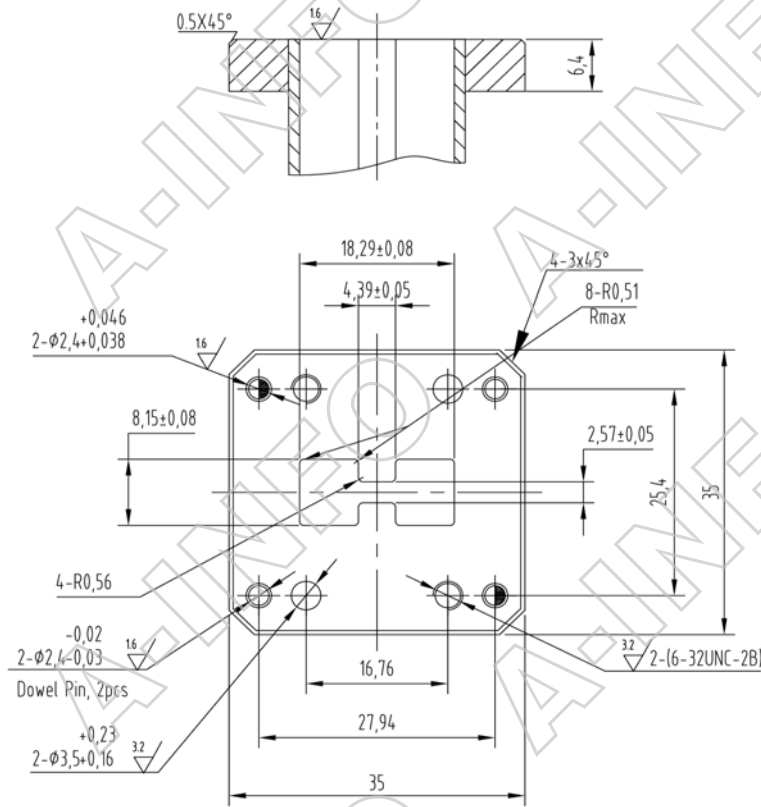

## Test Results

### 1. Gain

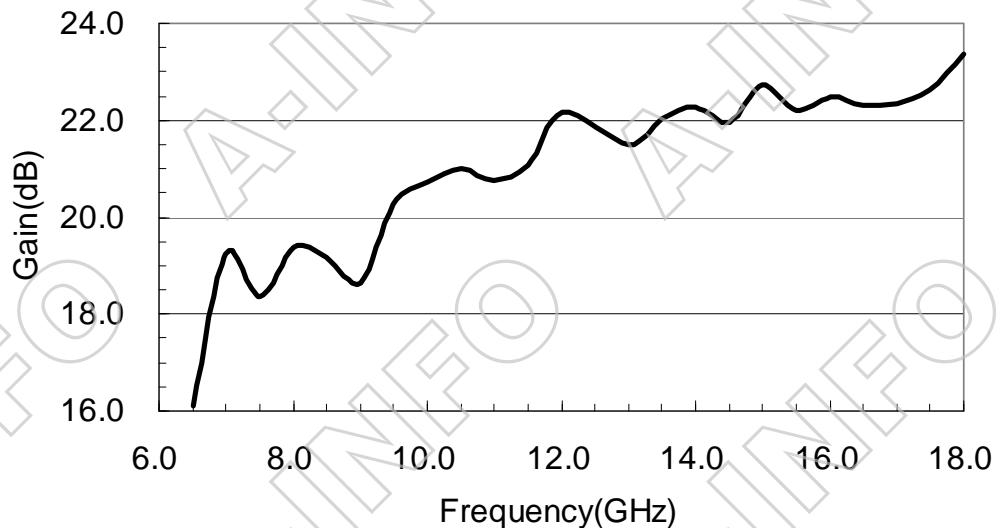

## 2. Cross Polarization Isolation

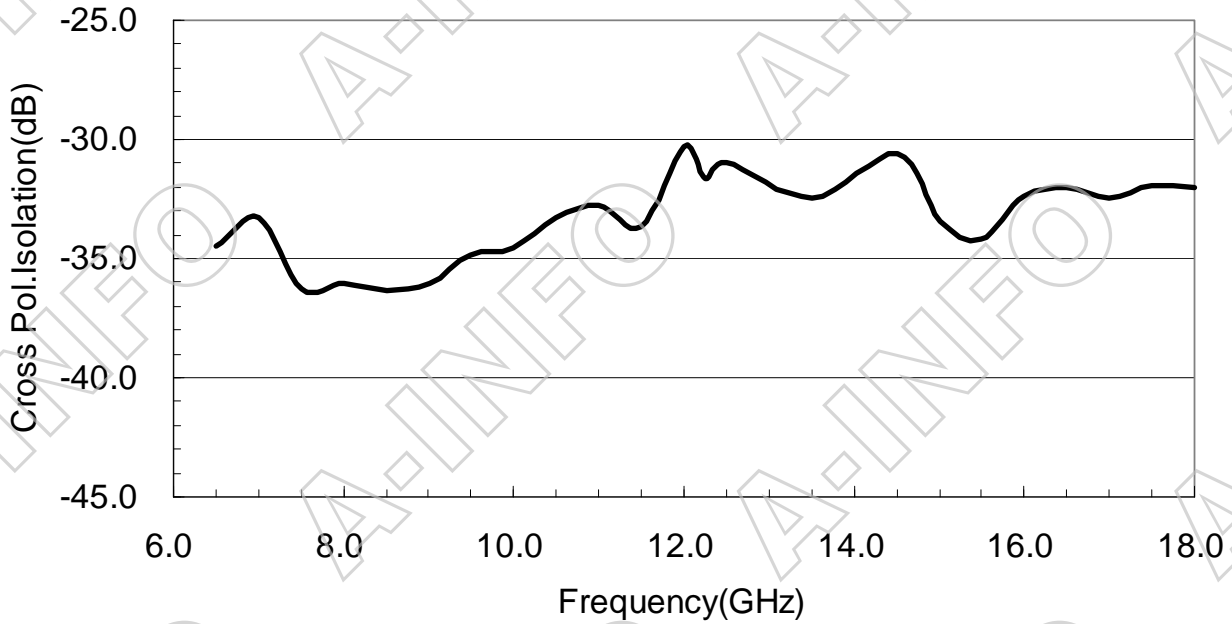

## 3. VSWR

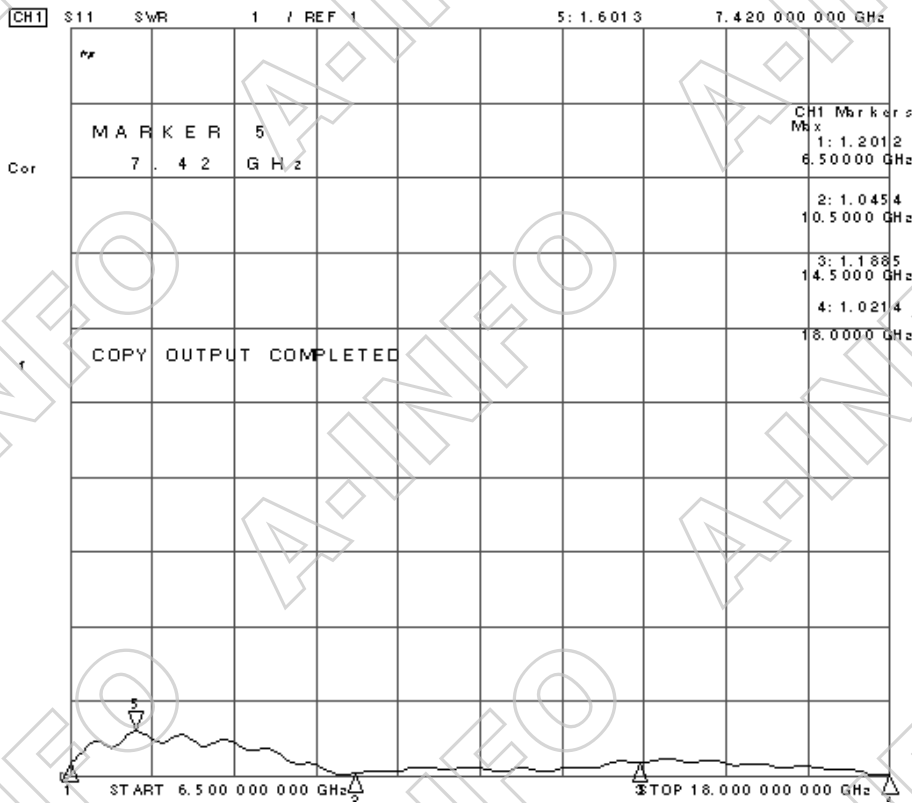

## 4. Pattern

6.5GHz

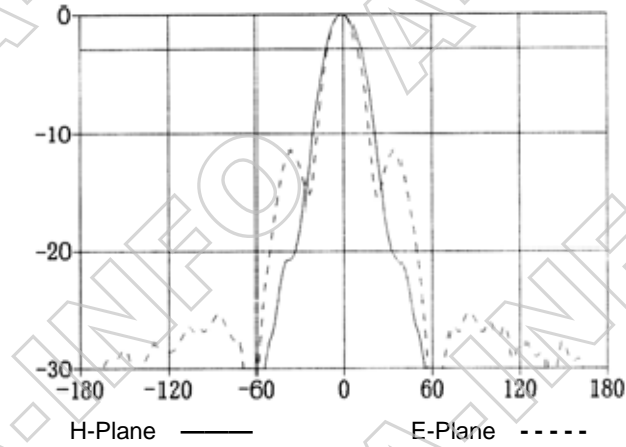

3dB Beamwidth (deg): 23.76    3dB Beamwidth (deg): 20.31

7.0GHz

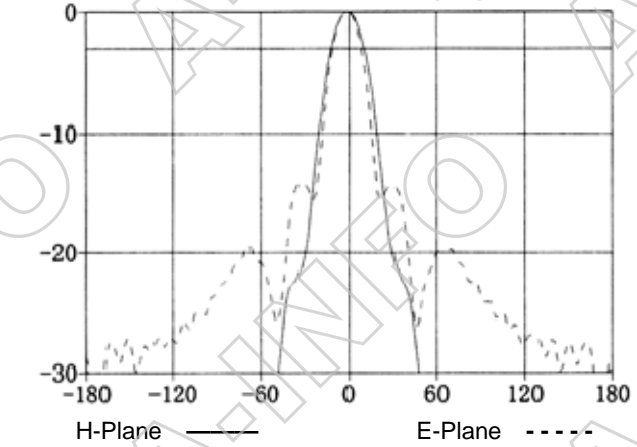

3dB Beamwidth (deg): 22.14    3dB Beamwidth (deg): 19.04

7.5GHz

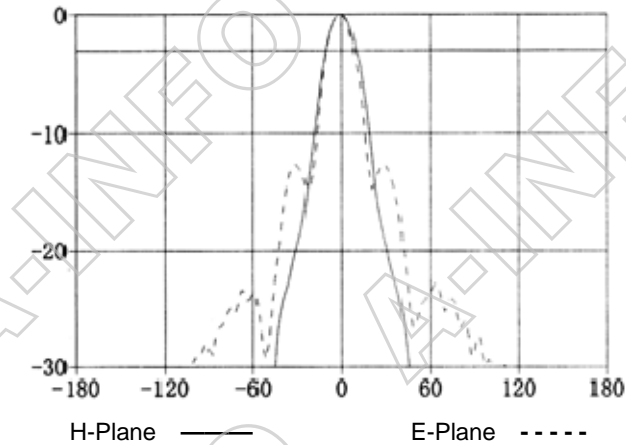

3dB Beamwidth (deg): 20.42    3dB Beamwidth (deg): 18.21

8.0GHz

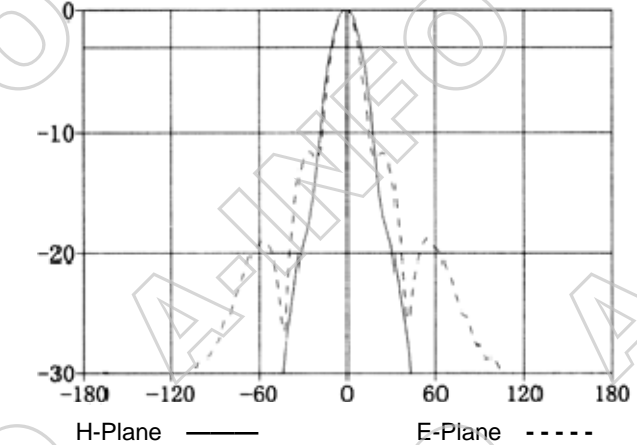

3dB Beamwidth (deg): 19.68    3dB Beamwidth (deg): 16.95

8.5GHz

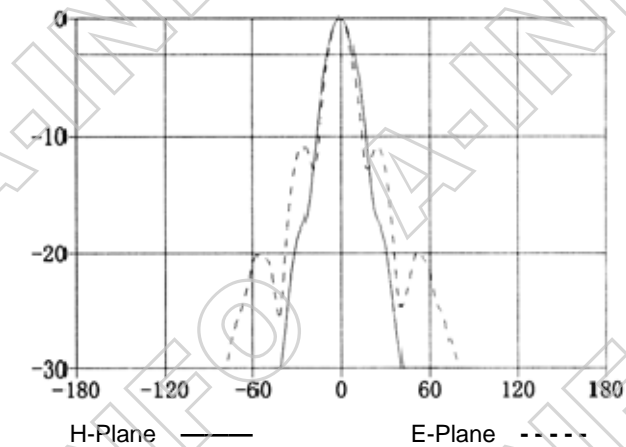

3dB Beamwidth (deg): 18.10    3dB Beamwidth (deg): 15.63

9.0GHz

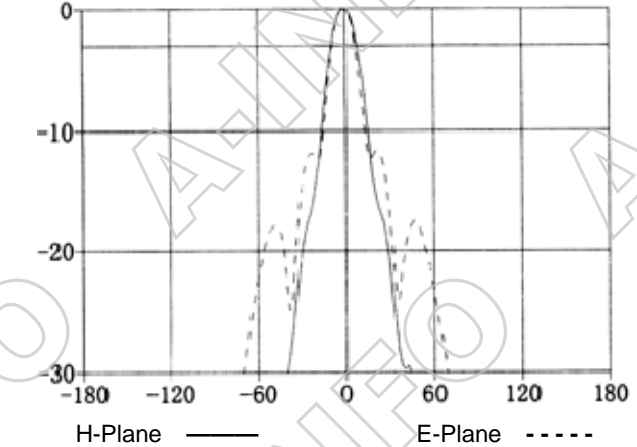

3dB Beamwidth (deg): 16.98    3dB Beamwidth (deg): 14.90

