

## Outline Drawing (Size: mm)

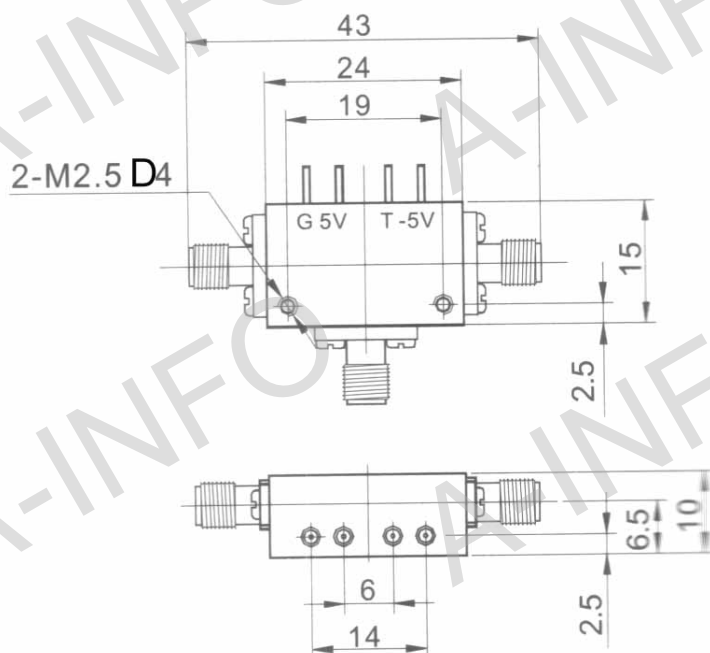

## Technical Specification

| Item                      | Technical Specification |
|---------------------------|-------------------------|
| Frequency Range(GHz)      | 0.5-18                  |
| Insertion Loss(dB)        | 3.5                     |
| Isolation(dB)             | 60                      |
| VSWR                      | 2.0                     |
| Switching Speed(ns)       | 50 max                  |
| Power Handling(W)         | 0.2 CW max              |
| Operating Temperature(°C) | -55 ~ +85               |
| Storage Temperature(°C)   | -65 ~ +125              |

## Test Results

### 1. Insertion Loss

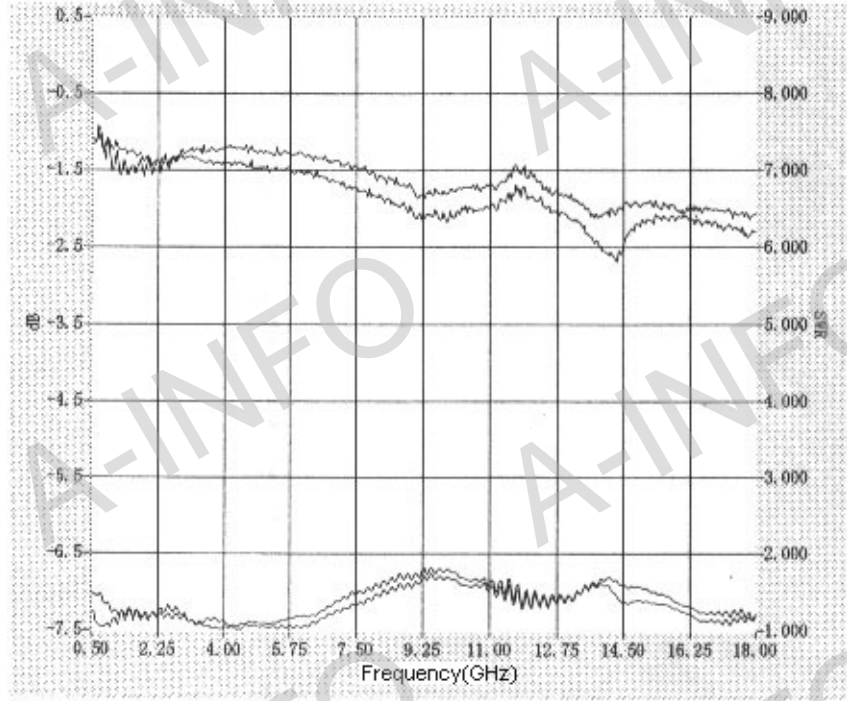

### 2. Isolation

