

▪ **Outline Dimension Drawing**

Dimensions: mm[inch]

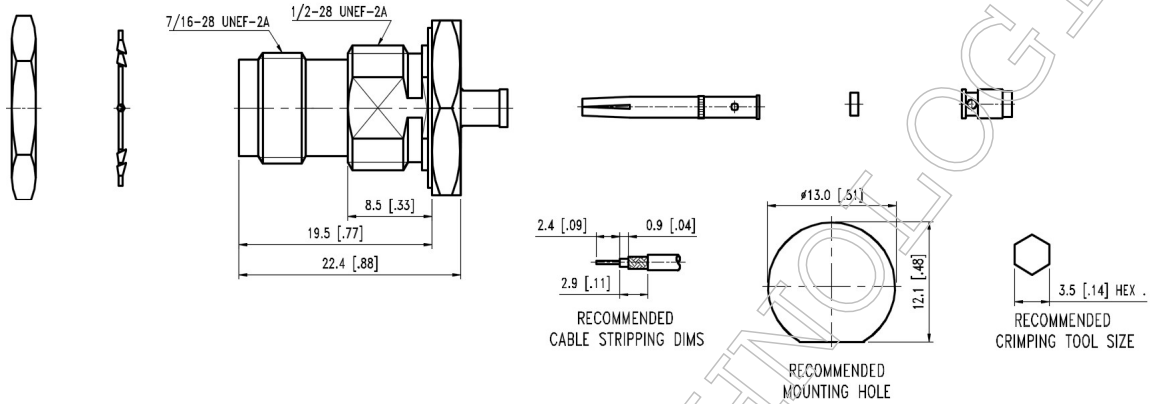

▪ **Material Specification**

| Description | Material | Plating |
|--------------|----------|---------|
| Body | Brass | Nickel |
| Contact | P.Bronze | Gold |
| Dielectric*2 | PTFE | |
| Ring | Brass | Gold |
| Washer | Brass | Nickel |
| Gasket | S.I.R | Orange |
| Nut | Brass | Nickel |
| Washer | Brass | Nickel |

In the effort to improve our products, we reserve the right to make changes judged to be necessary

▪ Electrical Specification

| Description | | Description | |
|---------------------------------|---------------|--------------------------|--------------|
| Impedance | 50 Ω | Insulation Resistance | 5000 MΩ Min. |
| Frequency | 6 GHz | Inner Contact Resistance | 3.0 mΩ Max. |
| VSWR | 1.3 Max. | Outer Contact Resistance | 2.0 mΩ Max. |
| Insertion Loss | 0.15 dB Max. | | |
| Voltage Rating | 170 Vrms Max. | | |
| Dielectric Withstanding Voltage | 330 Vrms Max. | | |

▪ Mechanical Specification

| Description | | Description | |
|--------------------------|------------|------------------------|---------------|
| Center Contact | | Recommended Torque | 10~12 in. lbs |
| Axial Force-Mating End | N/A lbs. | Coupling Nut Retention | N/A lbs. Min. |
| Axial Force-Opposite End | N/A lbs. | | |
| Connector Durability | 500 cycles | | |
| Weight | N/A g | | |

▪ Environmental Specification

| Description | |
|------------------|--------|
| Temperature Min. | -65 °C |
| Temperature Max. | 165 °C |
| Hermetic Seal | N/A |

In the effort to improve our products, we reserve the right to make changes judged to be necessary