

## Technical Specification

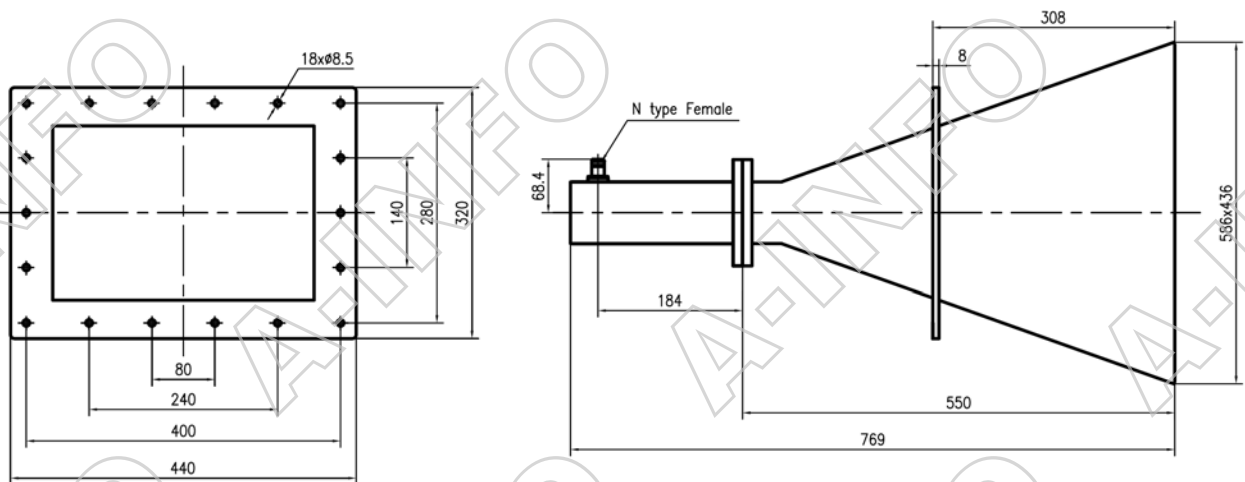

Frequency Range(GHz)	1.0-2.5
Polarization	Linear
Gain(dB)	14.5-19 Typ.
VSWR	1.5 Typ.
Connector	N-Female or 7/16-Female
Power Handling(W)	500 Max. CW
Size(mm)	586 x 436 x 769
Net Weight(Kg)	10.4 Around

## Outline Drawing (Size: mm)



## Test Results

### 1. Gain

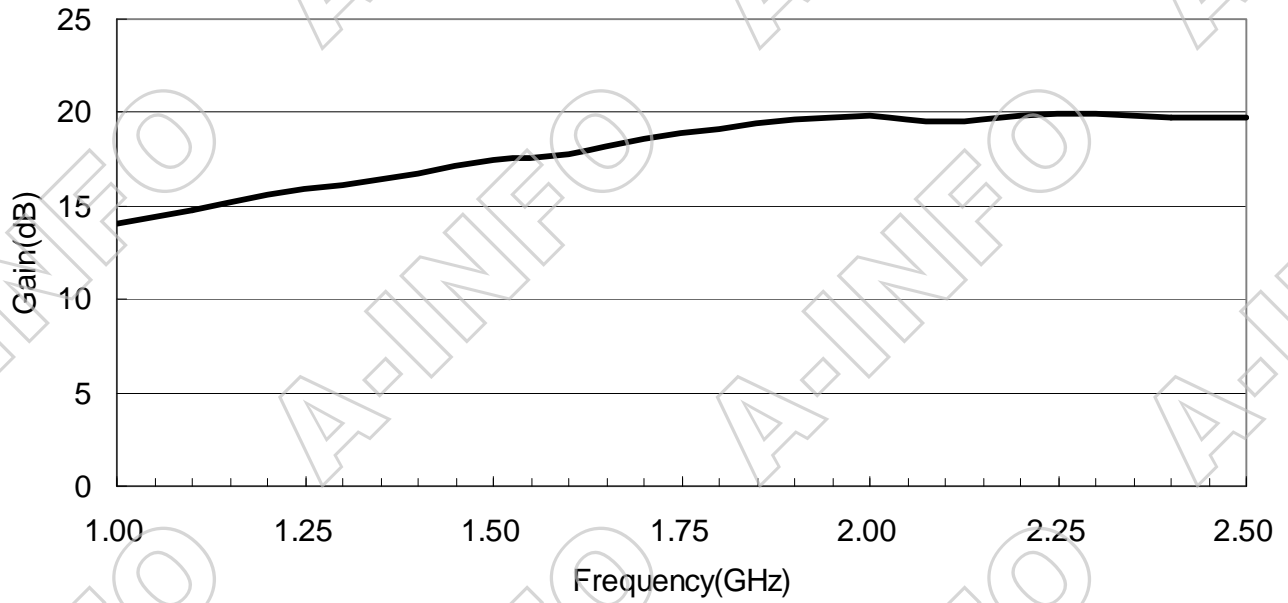

### 2. VSWR

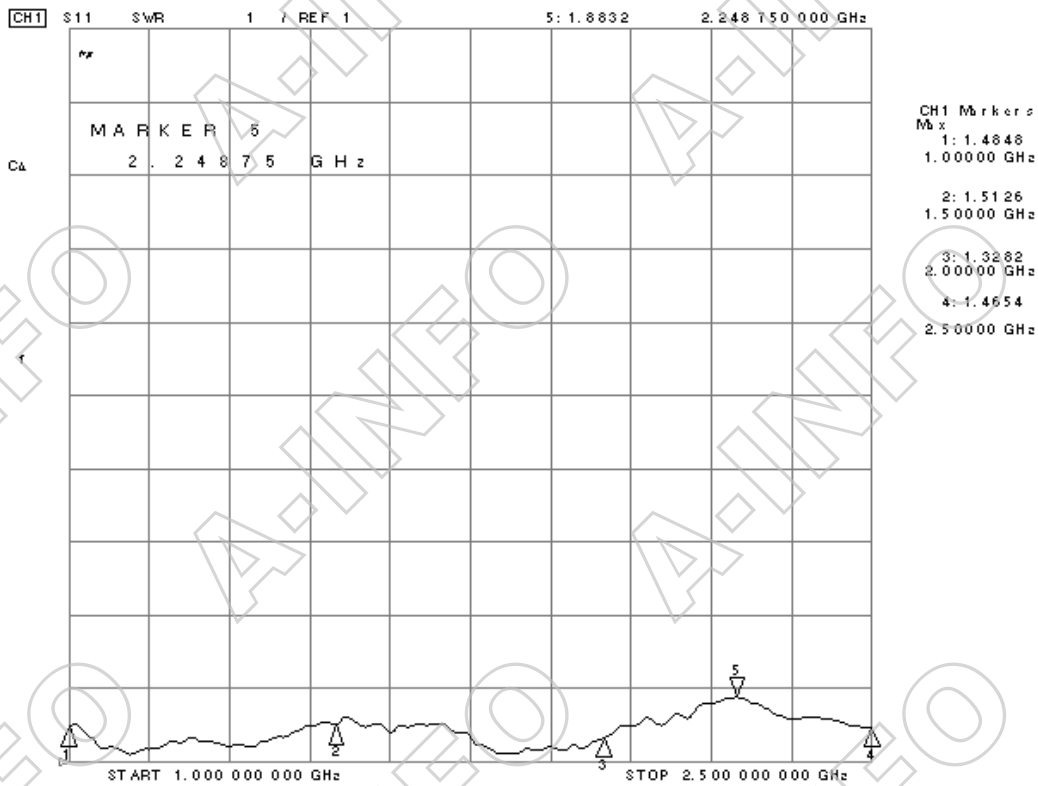

### 3. Pattern

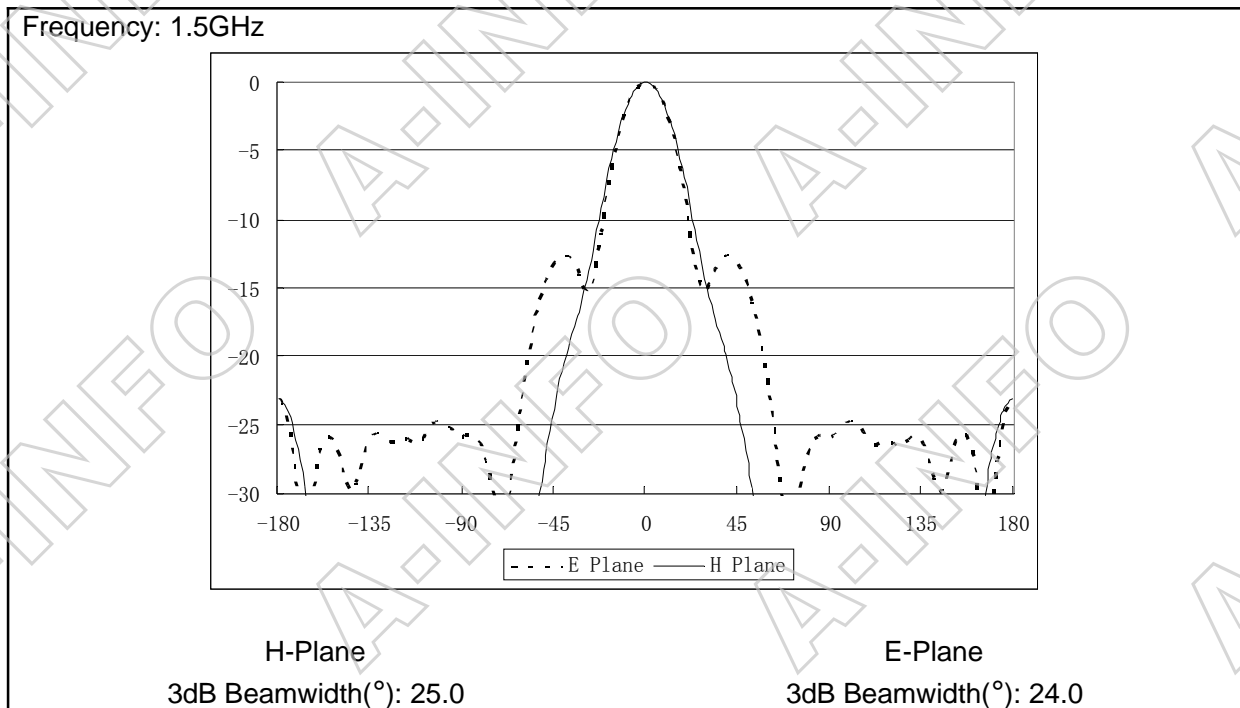
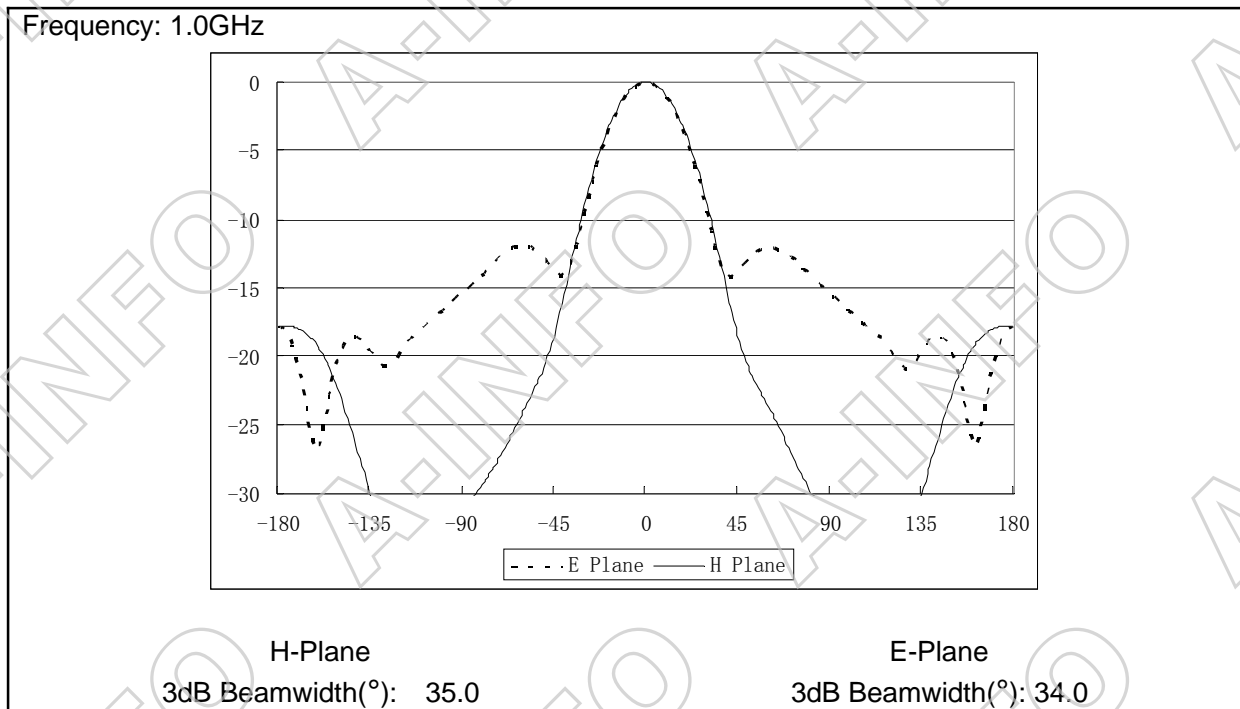

Frequency: 2.0GHz

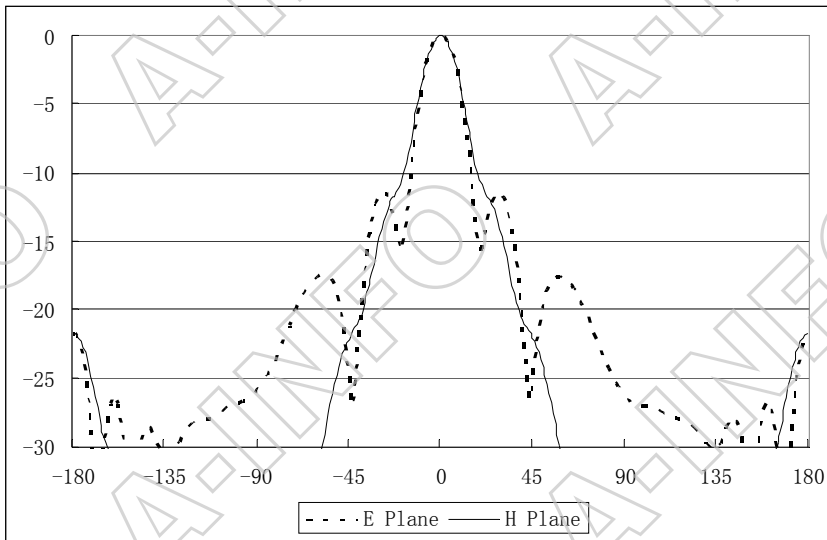

H-Plane  
3dB Beamwidth(°): 18.0

E-Plane  
3dB Beamwidth(°): 17.4

Frequency: 2.5GHz

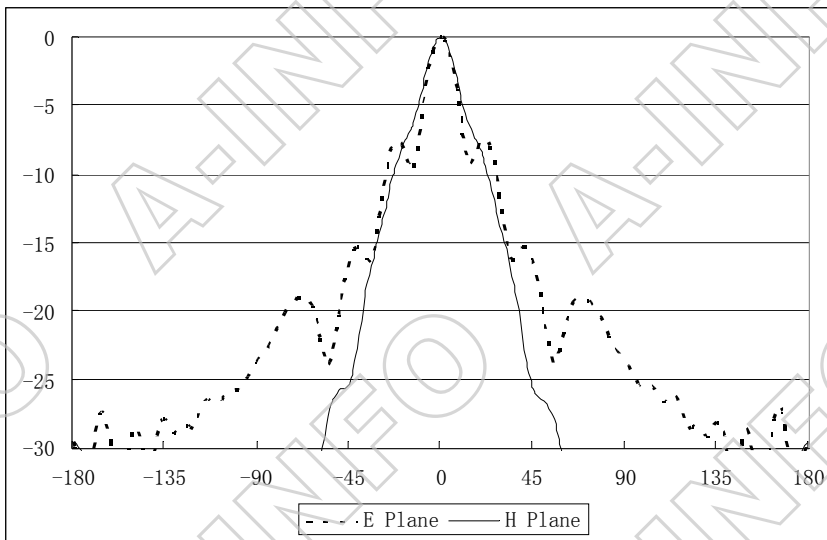

H-Plane  
3dB Beamwidth(°): 16.0

E-Plane  
3dB Beamwidth(°): 14.0